

RevNo	Revision note	Date	Signature	Checked
00	Sketch Only	05/25/2019		

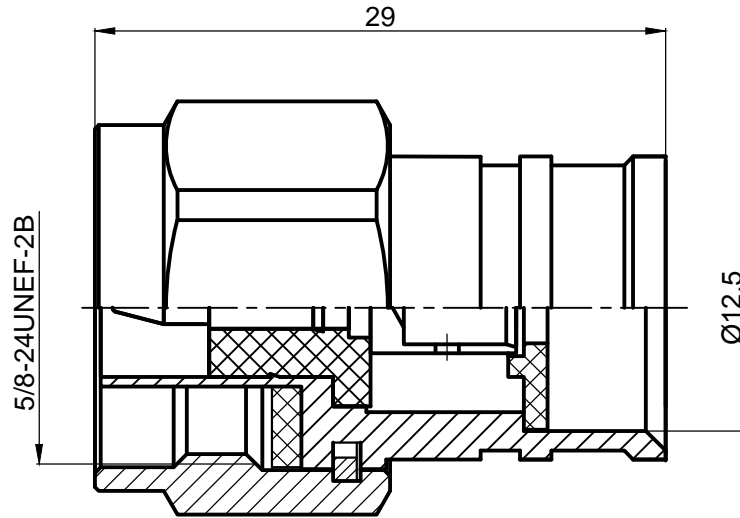

Material & Finishing:

1. Center condutor: Brass, Silver Plating
2. Insulators: PTFE
3. Body : Brass, Ternary Alloy Plating
4. Other Metal Parts: Brass, Nickel Plating
5. Gasket: Silicone Rubber

Electrical Data:

1. Impedance: 50 Ohms
2. Frequency: 0~6 GHz
3. VSWR: 1.2(0~3 GHz)
4. Proof Voltage : 1500Veff
5. Working voltage: 1000 Veff

RoHS Compliant.

ALL DIMENSIONS ARE IN MILLIMETERS AND [INCHES]

Unit:mm

RayNool
Raynool Technology Co., Ltd.

Title			
N MALE FOR 1/2 SUPERFLEX CABLE			
Drawn by	Ckd by	Appd by	Date
			05/25/2019
Scale	Sheet 1 of 1	3650506	
2:1			

UNLESS OTHERWISE NOTED
ALL SURFACES FINISHED TO 64/ MAX.

ALL TOLERANCES ARE:

DECIMALS	FRACTIONS	ANGLES
x ± 1.0	±1/64	x° ± 1°
x.x ± 0.5		x'x' ± 0.5'
x.xx ± 0.1		

THESE DRAWING & SPEC. ARE THE
PROPERTY OF Raynool
AND SHALL NOT BE REPRODUCED,
OR COPIED OR USED AS THE BASIS
FOR THE MANUFACTURE OR SALE OF
APPARATUS OR DEVICES WITHOUT
THEIR EXPRESS WRITTEN CONSENT.